

Welcome to ADVANCE

Many thanks for deciding on an ADVANCE quality product, complete with Swiss engineering.

Manual online

This guide gives a short look at dealing with the BIPRO 3, but does not replace the manual, which you can download on www.advance.ch/download

Product Registration

Register your BIPRO 3 in your MyADVANCE Account on www.advance.ch/warranty, and find out promptly by Email about updates and safety-relevant information.

Have fun

We wish you much rewarding experience with your BIPRO 3 and many wonderful hours in the air!

Important Notice

Every pilot carries sole responsibility for all risks associated with paragliding, including injury and death. Neither the manufacturer nor the seller of paragliding equipment can guarantee the safety of the pilot or be held responsible for it.

Delivery & Options

Before delivery every ADVANCE product has to be checked by the dealer for a complete delivery package and correct basic settings.

The BIPRO 3 delivery package contains:

- Harness
- Two-chamber foam protector
- Four flap reserve inner container connected to its own reserve handle
- Detachable Selfie-Stick holder
- Getting Started booklet

Available as options:

- Tandem spreaders that go perfectly with the BIPRO 3: Hard Hybrid, Soft and Soft Trim versions including main support quicklinks
- Reserve connection line kit for use with other spreaders
- FASTPACK BI fast-packing pack
- COMFORTPACK, 130 I, 145 I



Features

- 1 Velcro (for a micro vario)
- 2 Reserve V-connection channel with zip
- 3 Tube pocket for neat stowage of reserve connection lines
- 4 Back storage with separate internal pocket
- 5 Outer container with Labyrinth closure
- 6 Selfie-Stick holder, can be attached right or left
- 7 1 open side pocket (right), 1 zip-up (left)
- 8 Edelrid Triple-Lock buckles on the front strap
- 9 Comfortable V-Legpads
- 10 Mini chest strap
- 11 Robust 10 mm YKK zip fastener
- 12 Easy Fold Feature for easy mushroom-ing and packing



Installing the Reserve

Fitting the reserve should be done by a qualified person, your safety depends on it! The BIPRO 3 manual explains each step in detail. Make sure that your reserve conforms to the certified volume for the BIPRO 3 of 5 to 9 litres.

As a very rough approximation you can use the following wt/volume factor (reserve weight in kgs x 2.7 = Vol in ltrs).

Depending on packing style and quality a reserve which conforms to the certified volume range, according to this formula,

may still not release faultlessly. In every case the only way of confirming correct function is to carry out a personal test release/compatibility check, to prove that the particular reserve/ BIPRO 3 combination works.

! **Caution:** Only use the original release handle as attached to its original inner container.

Closing the Harness

The BIPRO 3 has the reliable ADVANCE Get-Up closure system with two Edelrid Triple-Lock buckles.

Lead the open buckle end **1** over the hook with the yellow safety catch and pull both strap ends outwards **2**. A clear “clack” sound shows that the buckle is securely closed. To open, press the yellow knob **3** and take the buckle end off the hook.

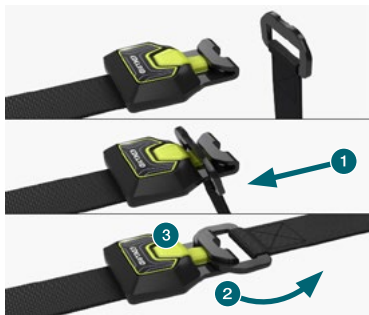

Adjusting the Harness

The BIPRO 3 is delivered with all straps at their basic settings: this means that shoulder, back and seat angle straps, both sides, are set to the grey markings. To set your own ideal positions you should start from the basic settings. The passenger harness can have a considerable effect on the pilot's sitting position. We therefore recommend that adjustments are made with a passenger harness; both harnesses attached to spreaders hung in a harness stand.

1. Adjusting the back straps

The relatively high set back straps at the sides provide good support for the back, and take pressure off the shoulders. Back straps pulled in achieves an upright sitting position. Completely loosened back straps results in a more reclining posture. ADVANCE recommend the basic setting.

2. Shoulder strap adjustment

Shoulder straps should be set to suit your height and desired sitting position. The Neoprene covered adjusters are at hip level and can be set to any position. Ideally

the shoulder straps should be quite loose in flight and not press on the shoulders, but still provide comfortable support.

3. Seat angle adjustment

Two buckles at the sides adjust the BIPRO 3 seat angle. This additional seat bracing provides very good seating comfort in flight. Adjust these straps symmetrically.

Packing

The Easy Fold Feature, an obvious hinge function at protector level, makes BIPRO 3 folding simple and compact. Fold the back on to the legpads and push these forward together for an even more compact result. Finally stow the harness in the packsack.



Optional Spreaders and Kit

There are three different, weight-optimised spreader versions (Hard Hybrid, Soft, Soft Trim) available as options for the BIPRO 3. Hard Hybrid and Soft Trim are quickout-capable. Reserve connection lines are permanently fixed to the spreaders **3**. The BIPRO 3 connects to the spreaders **2** by neoprene-covered quicklinks **4** which replace carabiners. Then the reserve connection lines lead to the reserve **5** via stowage of their excess lengths in a tube pocket on a BIPRO 3 shoulder strap.

An optional reserve connection kit is available if the BIPRO 3 is to be used with other spreaders. This kit contains two connection lines, two 5 mm Maillon Rapide quicklinks and their Neoprene covers. These quicklinks are specifically intended for connecting spreaders to the BIPRO 3

Hard-Hybrid-Spreaders (295 g*)

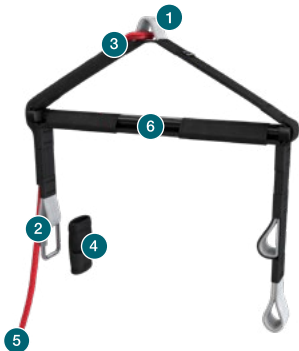

- 1 Tandem support point
- 2 Pilot harness attachment point
- 3 Reserve connection line fixed to the spreader
- 4 Support quicklink Neoprene covers
- 5 Reserve connection lines stowed in the BIPRO 3 tube pocket
- 6 Removable carbon rod – the Hard-Hybrid-Spreaders can also be converted into Soft.

* incl. connection lines, main quicklinks and Neoprenes

Soft-Spreaders (175 g*) Soft-Trim-Spreaders (237 g*)



- 1 Tandem support point
- 2 Pilot harness attachment point
- 3 Reserve connection line fixed to the spreader
- 4 Support quicklink Neoprene covers
- 5 Reserve connection lines stowed in the BIPRO 3 tube pocket
- 6 Trimmer for adjusting pilot harness height

* incl. reserve connection lines, quicklinks and Neoprenes

Reserve Connection Routing

The combination of BIPRO 3 and its optional spreaders benefits from tidy stowage of reserve connection lines. These lead from the spreaders, via a small Velcro loop on the quicklink covers direct to the shoulder strap where they are stowed in a tube pocket. From there they connect to the reserve.



Warranty & Service

If you register your product on your MyADVANCE-Account within ten days of purchase you can benefit from the extended ADVANCE-Warranty. This is valid for three years for deficiencies attributable to manufacturing faults. Otherwise the warranty of your country applies.

In the MyADVANCE-Account you can find all the documentation for your harness as PDF, e.g. the manual, special information, safety updates and much more. There you

can also see spare parts for your product and contact Support with any queries.

Your BIPRO 3 should have a thorough visual check every 24 months and be regularly inspected. Detected damage requires the harness to be immediately sent to an authorised service centre. You can find out more about the worldwide ADVANCE Service Network on www.advance.ch.

Technical Data

BIPRO 3

		M	L
Pilot height	cm	155–185	175–202
Harness weight	kg	2.05	2.20
Protector weight	g	522	522
Reserve container weight	g	130	130
Selfie-Stick holder weight	g	25	25
Back pocket volume	l	26	34
Main support height	cm	40	42
Certification		EN 1651 / LTF 91/09, 120 kg	

ADVANCE

advance thun ag
uttigenstrasse 87
ch 3600 thun

+41 33 225 70 10
www.advance.ch

info@advance.ch
support@advance.ch



Getting Started

ADVANCE BIPRO³

English